

# TWO-PLY SUPER JUMBO TEX<sup>®</sup>

WEATHER-RESISTIVE BARRIER

60  
MINUTE

PROFESSIONAL

## Part of a Complete Moisture Control System

Two-Ply Super Jumbo Tex 60 Minute is the flagship product of the Jumbo Tex family – a product line that has set the industry standard for effectiveness and durability as a weather-resistive barrier behind all major exterior wall claddings. It has been chosen by builders and architects to protect over *five million* homes and commercial buildings

from the problems caused by water intrusion and excessive moisture.

Two-Ply Super Jumbo Tex 60 Minute is engineered for residential and commercial construction applications that demand the maximum water and moisture protection available. Delivering over fifteen times the minimum water resistance requirement for Grade “D” paper, it has the toughness to

“*Engineered for the most demanding residential and commercial construction applications that require maximum water and moisture protection...*”

survive the most rugged of jobsites. The product is part of a complete Moisture Control System for walls engineered by the Fortifiber Building Systems Group<sup>®</sup>, which helps manage and eliminate moisture-related problems – including water-related structural failures, mold and mildew.

Two-Ply Super Jumbo Tex 60 Minute provides the ideal balance between water protection and vapor permeability, to keep walls dry and homes comfortable. The product also reduces air infiltration in exterior walls, contributing to energy savings.

Two-Ply Super Jumbo Tex 60 Minute is comprised of two layers of asphalt-saturated building paper, which is considered by many building science experts to provide the ideal drainage plane behind exterior claddings, and to increase the drying potential of the wall system when wet. Dual layers also result in better sealing around attachment fasteners and better building envelope integration. Unlike some plastic housewraps, it will retain its weather-resistive properties when exposed to either jobsite surfactants or wood extracts and tannin derivatives from wood siding.

## Unique Weather-Resistive Properties

The product’s pliability and 40 inch wide roll size make it easier to install and store on the jobsite than other weather-resistive building materials. It is also more cost-effective than plastic housewraps, while offering the most formidable defense against water intrusion and moisture problems. When the code requires two layers of Grade “D” building paper, Two-Ply Super Jumbo Tex 60 Minute does the job in one pass, saving costly labor dollars. In addition, it outperforms plastic housewraps in protecting against water intrusion – while providing vapor permeability behind stucco, fiber cement siding, brick, vinyl and wood siding.

## Decades of Proven Performance

Two-Ply Super Jumbo Tex 60 Minute is a product manufactured by the Fortifiber Building Systems Group. With more than a seventy-year history of proven performance, technical expertise and practical know-how, the company has become a trusted partner to builders, architects and code officials.

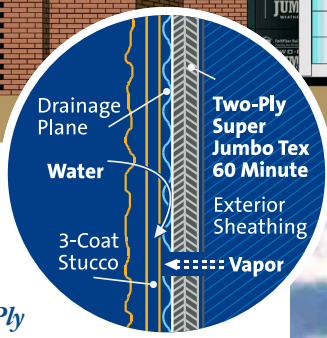
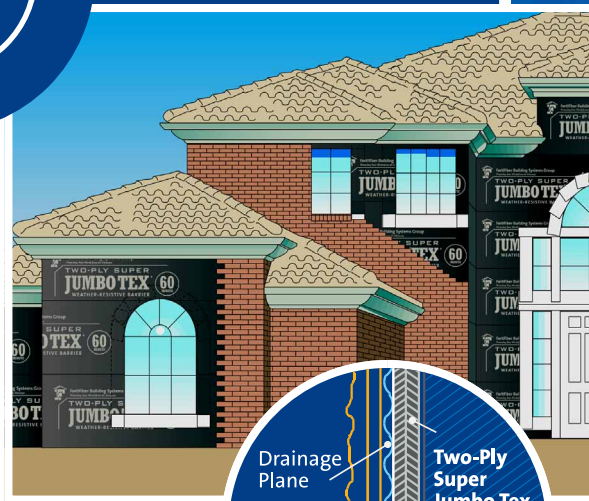

*Two-Ply Super Jumbo Tex 60 Minute protects against water intrusion from the outside, while allowing moisture to escape from the inside.*

- THE MOST FORMIDABLE DEFENSE AGAINST MOISTURE PROBLEMS
- EXCEPTIONAL WATER RESISTANCE
- EXCELLENT PRICE-PERFORMANCE
- BREATHABLE WEATHER-RESISTIVE BARRIER
- FOR STUCCO, FIBER CEMENT SIDING, BRICK, VINYL AND WOOD SIDING
- LABOR SAVINGS FOR TWO-PLY CODE REQUIREMENTS
- REDUCES AIR INFILTRATION



# TWO-PLY SUPER JUMBO TEX 60 MINUTE

**Product Description:** Two-Ply Super Jumbo Tex 60 Minute is a professional grade weather-resistive barrier designed for use within a variety of exterior wall assemblies. It provides excellent protection from internal wall damage due to water intrusion and condensation.

**Composition:** Two-Ply Super Jumbo Tex 60 Minute is an asphalt-saturated kraft Grade "D" breather type sheathing paper.

**Size & Weight:** Two-Ply Super Jumbo Tex 60 Minute is available in 40" x 162 sq. ft. rolls. Product weight is approximately 12 lbs/100 sq. ft.

**Applicable Standards:** Exceeds Federal Specification UU-B-790a, Type 1, Grade "D", Style 2.

Complies with the Uniform Building Code Standard 14-1.

Complies as an alternative to the water-resistive barrier specified in Section 1404.2 of the International Building Code®.

Complies as an alternative to the weather-resistant sheathing papers specified in Section R703.2 of the International Residential Code®.

ICC ESR-1027, BOCA Evaluation Report No. 2146, SBCCI Evaluation Report No. 2103 and CCMC Evaluation Listing No. 13142-L.

American Society for Testing & Materials (ASTM):

- ASTM D-779 - Standard Test Method for Water Resistance of Paper, Paperboard and Other Sheet Materials by the Dry Indicator Test Method
- ASTM D-828 - Tensile Properties of Paper and Paperboard Using Constant-Rate-of-Elongation Apparatus
- ASTM E-96 - Water Vapor Transmission of Materials

**Physical Properties:** Two-Ply Super Jumbo Tex 60 Minute is continually tested in accordance with ASTM procedures. The values shown in Table 1 are averages obtained in these tests.

**Limitations:** Product should be covered as soon as possible. Inspect product to insure it is free of any protrusions or damage which may detract from the weather-resistive barrier integrity. Holes, tears or punctures should be sealed

with Moistop® Sealant or Fortifiber Sheathing Tape. This product is not recommended for horizontal, roofing or below grade applications.

**Installation:** Two-Ply Super Jumbo Tex 60 Minute should be installed in accordance with the local applicable building code. The International Residential Code, Section R703.2, states that weather-resistive barriers should be applied horizontally, with the upper layers overlapping the lower layer by a minimum of 2" (3" is recommended), and all vertical joints should be lapped a minimum of 6". To ensure the integrity of the weather-resistive barrier system, Fortifiber strongly recommends the use of a Two-Ply Jumbo Tex product or two layers of a single ply Jumbo Tex product when used with a three-coat stucco system. Do not tape horizontal or vertical seams.

**Availability:** The Fortifiber Building Systems Group's products are distributed nationwide. For product information and pricing, please call a Fortifiber distributor near you. If you need assistance locating a participating distributor, please call our Customer Service Department at 1-800-773-4777.

**Fortifiber Warranty:** Fortifiber Corporation warrants that its products are in compliance with their published specifications and are free from defects in materials and workmanship for a period of two years from the date of purchase. This warranty does not apply to loss due to abuse. Material found to be defective will be replaced at no charge by Fortifiber, but in no event shall Fortifiber be liable for any other costs or damages, including any labor costs.

THIS EXPRESS WARRANTY IS GIVEN IN LIEU OF AND EXCLUDES ALL OTHER EXPRESS OR IMPLIED WARRANTIES, INCLUDING BUT NOT LIMITED TO THE IMPLIED WARRANTIES OF MERCHANTABILITY AND FITNESS FOR A PARTICULAR PURPOSE. Fortifiber's sole obligations under this warranty are as set forth herein. In no event shall Fortifiber be liable for any lost revenue or profits, direct, indirect, special, incidental or consequential damages of any kind.

This product may be eligible for Fortifiber's FortiShield 10 year warranty when used in conjunction with other Fortifiber products. Please see our website at [www.fortifiber.com/warranty.htm](http://www.fortifiber.com/warranty.htm) for details.

**SPECIFICATION SUMMARY:** Provides secondary weather protection behind exterior cladding to prevent moisture penetration and condensation in exterior wall assemblies.

**WEATHER-RESISTIVE BARRIER:** Fortifiber/Two-Ply Super Jumbo Tex 60 Minute asphalt saturated kraft 60 minute Grade "D" breather type sheathing paper.

**REFERENCE SPECIFICATION:** Federal Specification UU-B-790a, Type 1, Grade "D", Style 2.

*Table 1- Physical Properties*

CHARACTERISTIC	TEST METHOD	RESULTS	INDUSTRY STANDARD
Water Vapor Transmission	ASTM E-96 (A)	67 grams 10 perms (MVT)	35 grams (min.) 5 perms (MVT)
Water Resistance	ASTM D-779	150 minutes	10 minutes per ply
Tensile Strength	ASTM D-828	MD - 160 lb. <sup>f</sup> /inch CD - 110 lb. <sup>f</sup> /inch	MD - 20 lb. <sup>f</sup> /inch CD - 20 lb. <sup>f</sup> /inch



**Fortifiber Building Systems Group®**  
Protecting Your World from the Elements®

Call 1-800-773-4777 or 1-775-333-6400 for sales and technical assistance. On the Internet visit [www.fortifiber.com](http://www.fortifiber.com).

© 2011 Fortifiber Building Systems Group. Fortifiber®, FortiShield®, Jumbo Tex®, Moistop® Sealant and Protecting Your World from the Elements® are trademarks of Fortifiber Corporation. 10/11